

# INSTRUCTION FOR INSTALLING REPLACEMENT SEAT AND DIAPHRAGM ASSEMBLY

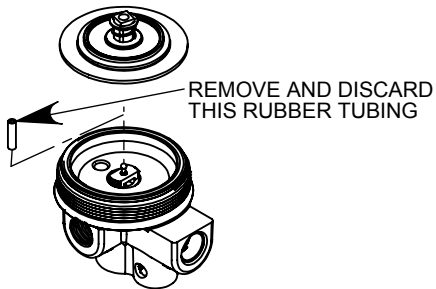

RIGHT WAY TO INSTALL THE DIAPHRAGM ASSEMBLY (SLIDE ONTO THE BALL)

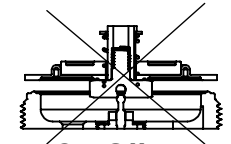

**WRONG!!**  
DO NOT SIT ON THE BALL

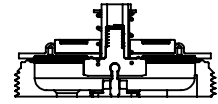

**THE RIGHT WAY**

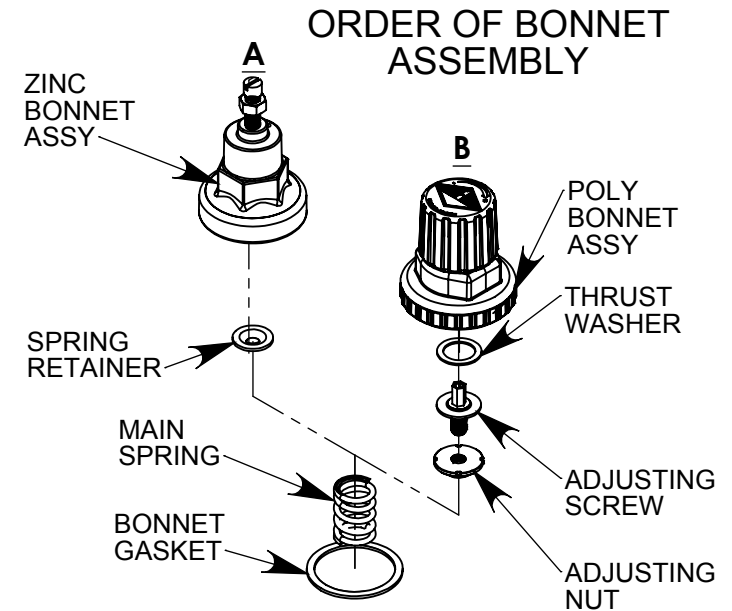

1. Turn off gas supply at tank. Loosen hose connection at tank to relieve the remaining gas pressure in the system. Then re-tighten the connection;
- 2A. For zinc bonnet - Loosen lock nut and back out adjusting screw as far as it will go;
- 2B. For poly bonnet - Pull bonnet cap up and turn counter-clockwise as far as it will go;
3. Remove bonnet assembly and components shown; remove diaphragm assembly; and remove the old seat capsule assembly and spring from regulator base;
4. Install new seat capsule assembly by threading it into the body. Tighten it firmly until a definite bottoming is felt (use 6" parallel pliers or T/R# 440-4PN wrench);
5. Remove and discard the piece of rubber tubing which held the capsule parts together;
6. Slide the diaphragm assembly onto the ball head of the capsule assembly as shown above; Slot should be oriented horizontally to retain diaphragm assembly while installing bonnet assembly;
7. Replace parts into bonnet in the order shown above; A. (Zinc) Bonnet, spring retainer, main spring and bonnet gasket; or B. (Poly) Bonnet, thrust washer, adjusting screw, adjusting nut, main spring and bonnet gasket;
8. Guide bonnet assembly over diaphragm and onto regulator base, and tighten until firm resistance is felt;
9. Turn on gas supply at tank. A. (Zinc) Turn adjusting screw for required pressure, and tighten lock nut. Check for leaks; or B. (Poly) Turn bonnet cap for required pressure, and lock cap into place by pressing it down. Check for leaks.